

OPTIMUM

ALUMINUM RAILING by 

COLUMN WRAP INSTALLATION INSTRUCTIONS

INSTRUCTIONS

- Please read all instruction completely before starting any installation.
- **SAFETY:** Always be safe and follow all instructions when using power tools and always wear safety goggles!
- Any questions? Call 844-332-5338 and ask for your railing specialist.
- Visit our website for videos and other information: www.optimumrailing.com.



IMPORTANT: Consult your local building code official and check all Code Requirements.

RECOMMENDED TOOLS & SUPPLIES

- Pry Bar
- 1/8" width Flat-head Screwdriver or Mini Pry Bar
- Shims or 5/8" treated wood for "packing" out the wraps**
- Rubber Mallet
- Tape Measure
- Speed Square

** Estimated size, must check before installation



NOTE: Fasteners are not included.



Column Wrap

INSTALLATION

STEP 1 CUT TO SIZE

Measure posts and cut Column Wrap pieces (4 ea) to size. Double check for correct sizing to the post



**MEASURE TWICE,
ORDER ONCE!**



STEP 2

PACK OUT SUPPORT POSTS AND FLASH

Use 5/8" treated wood to "pack out" the 4 X 4 or 6 X 6 treated "nominal" support the load bearing deck or roof (see engineering specs for correct sized lumber for load bearing). Use protective rubber flashing material to minimize contact of aluminum to treated lumber material.



STEP 3

SNAPPING THE 4 PIECE COLUMN WRAPS

Take the cut to size aluminum Column Wrap and check for sizing. Start with a single piece and begin to fit and snap the 4 pieces around the support column.

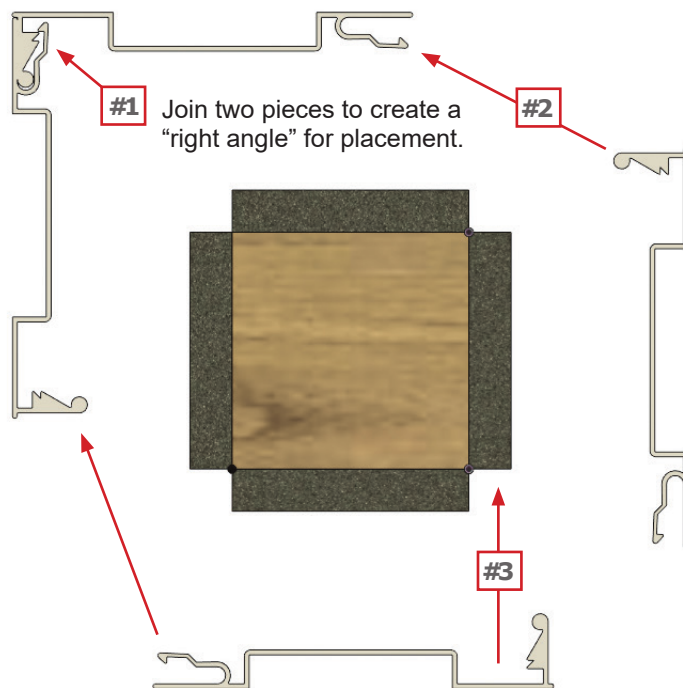

STEP 4 FINAL ASSEMBLY

Final assembly should look like these pictures. Only use the column wrap with load bearing posts for proper installation and load bearing.

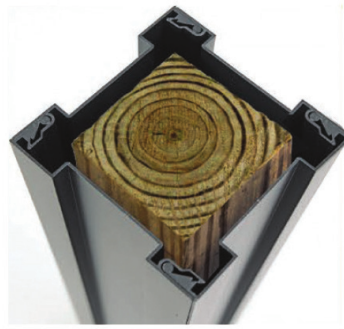
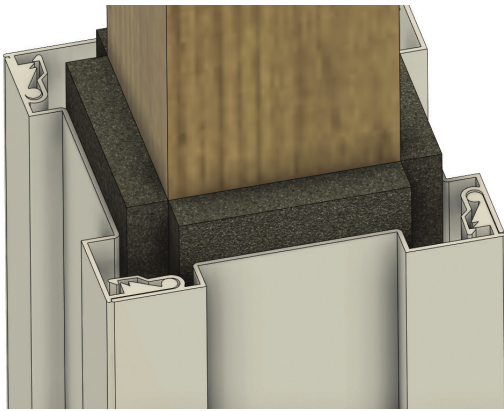

Column Wraps cannot be used alone to support any load-bearing structure

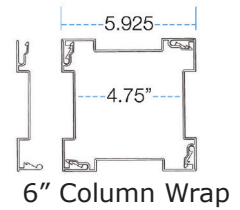

6" Column Wrap

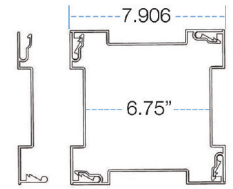

8" Column Wrap

STEP 5 OPTIONAL COLUMN LOCKS INSTALLATION

Use a rubber mallet and carefully "tap" the column lock pieces (grooved edge down and hidden by bases) for a raised column look. These are placed in by friction. You can use a small set #8 screw for a more secure attachment.

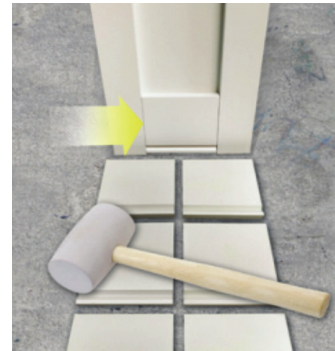
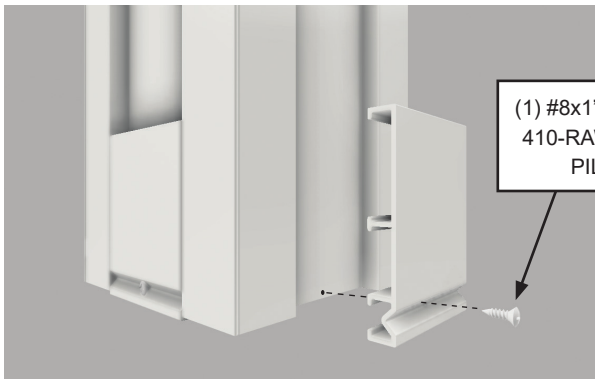

8 piece Column locks friction fit into channels

STEP 6 2 PIECE BASE

Use screw to attach the 2 piece base.

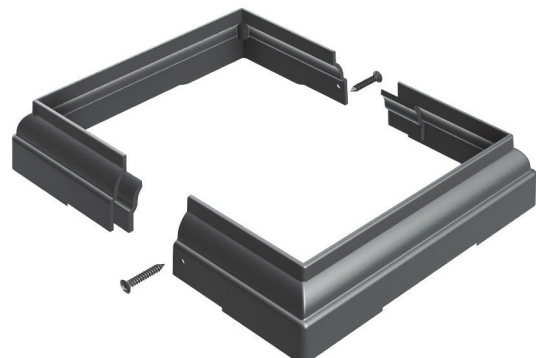

2 piece Base

FINAL INSTALLATION



OPTIMUM
ALUMINUM RAILING by **FDS**

543 E. 600 S. Provo, UT 84606

OptimumRailing.com | 844-332-5338