

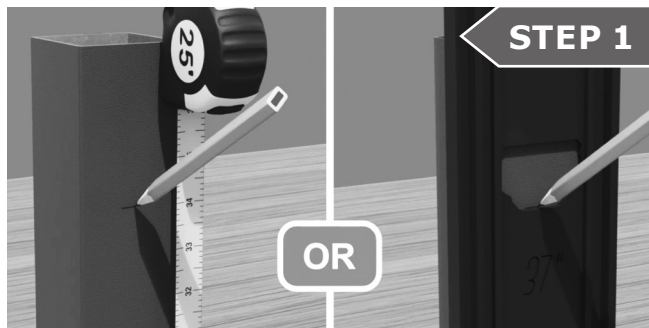

HORIZONTAL BRACKET TO HORIZONTAL BRACKET INSTALLATION

Our angled brackets are used whenever rails are not attached at right angles.



Marking the rail bracket placements on posts can be done either with a tape measure OR our bracket template.

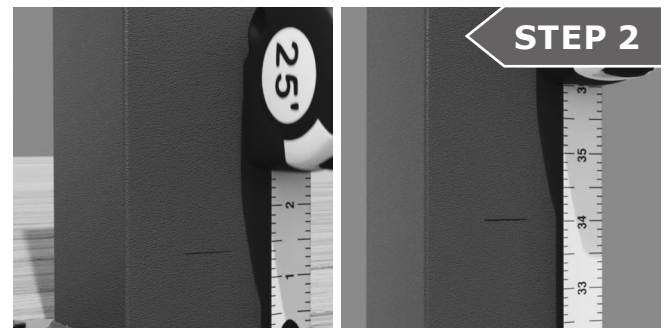

Measure 1-3/8" from the top of the flange and make a pencil mark at that height. Then place a pencil mark at 34" from the top of flange.



If you have our bracket template for 37" and 43" rails, place the template against the post and simply mark lines at the bottom of the desired bracket holes.

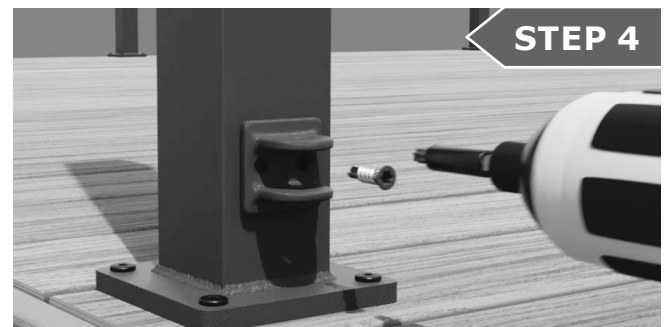

Place the angled bracket backer plate against the post horizontally at your mark and fasten to the post with two #14 Tek screws.

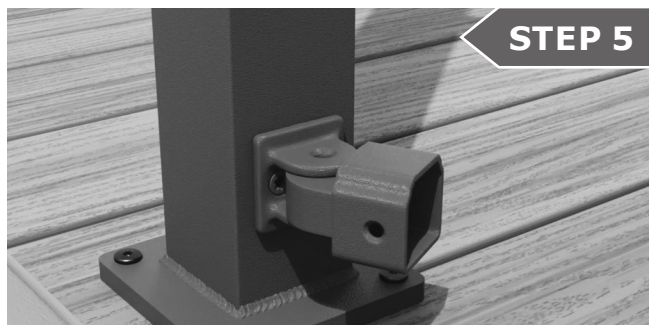

Press the four bracket cups into the backer plates and rotate towards each other.



Measure the distance between the inside of the bracket cups while allowing a 1/4" gap to the back of the cups at each end. Take note of the measurement.

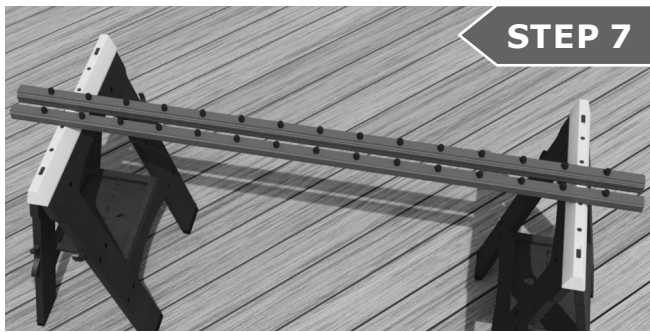

STEP 7

Place your rails on a flat surface, nubs side up, and mark your measurement with equal distances between the nubs, at both ends on both rails.

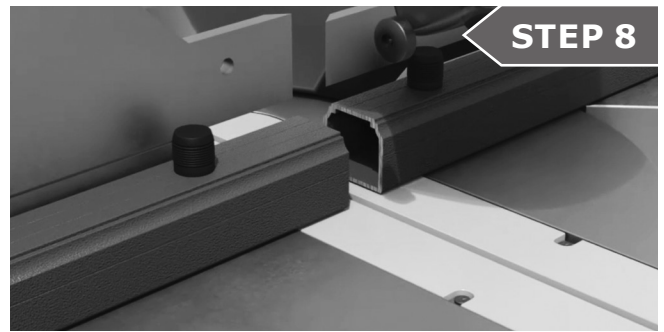

STEP 8

Cut the profiles square along your cut lines using a chop saw. Be sure to use a high tooth count blade.

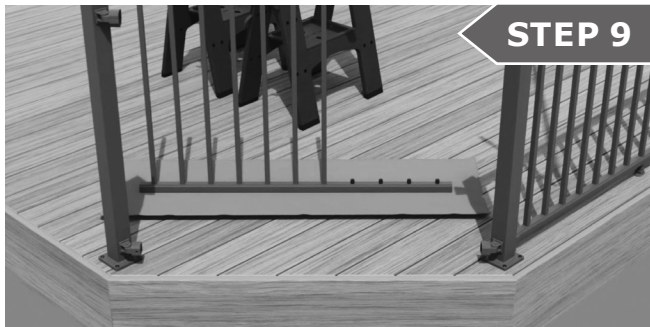

STEP 9

Assemble the rail section by first pressing the balusters onto the bottom rail nubs, then press the top rail nubs into the baluster tops. Use even force to fully seat all of the balusters.

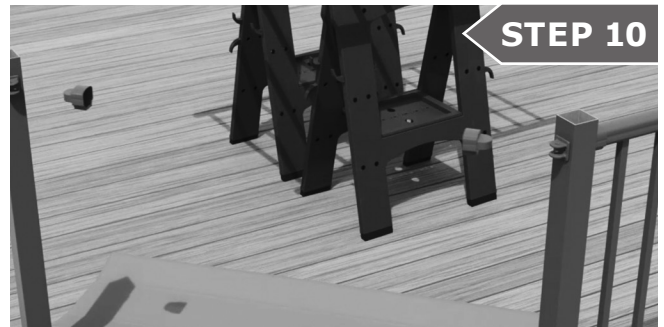

STEP 10

Position rail section with access to rail ends, then detach the bracket cups from the backer plates.

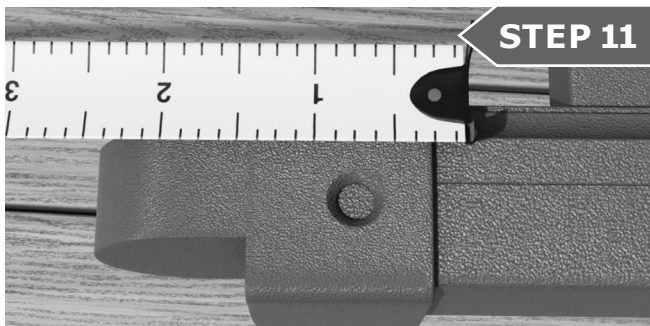

STEP 11

Place the bracket cups on the rails at both ends, leaving a 1/4" gap on each.



STEP 12

Fasten the bracket cups to the rails at both ends with #14 Tek screws.

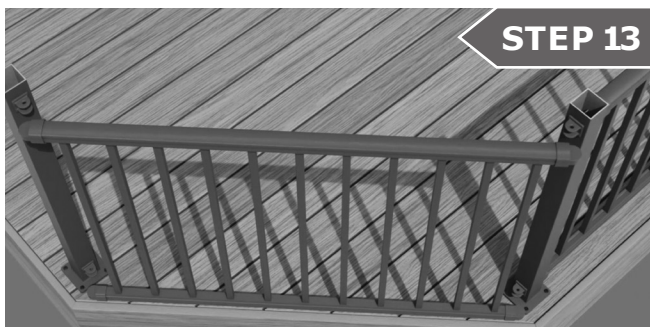
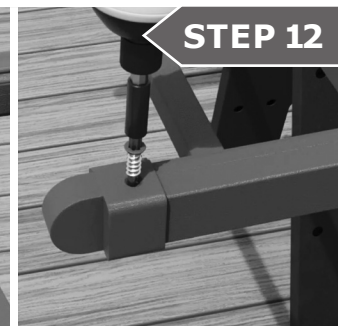

STEP 13

Position the rail section with the rail cups inserted evenly into all four backer plates.

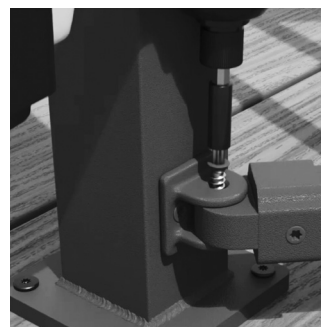

STEP 14

Attach the four rail cups to the four backer plates with #14 Tek screws. Use a rubber mallet to tap the post caps into place to finish the section.

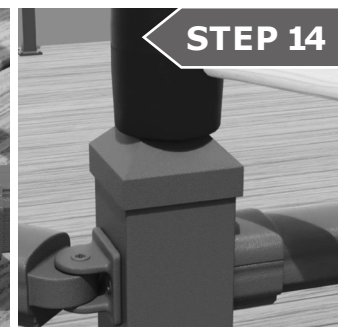

OPTIMUM
ALUMINUM RAILING by **FDS**

543 E. 600 S. Provo, UT 84606

844-332-5338 | OptimumRailing.com