

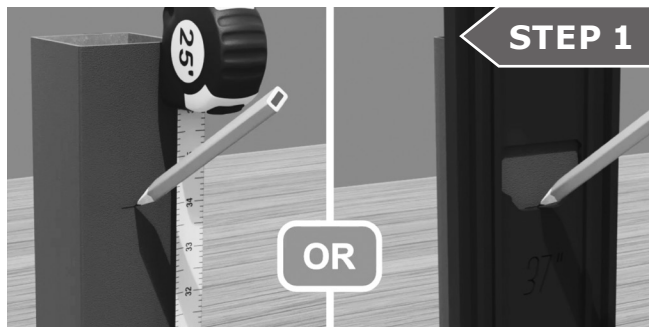

HORIZONTAL BRACKET TO LEVEL BRACKET INSTALLATION

Our angled brackets are used whenever rails are not attached at right angles.



Marking the rail bracket placements on posts can be done either with a tape measure OR our bracket template.

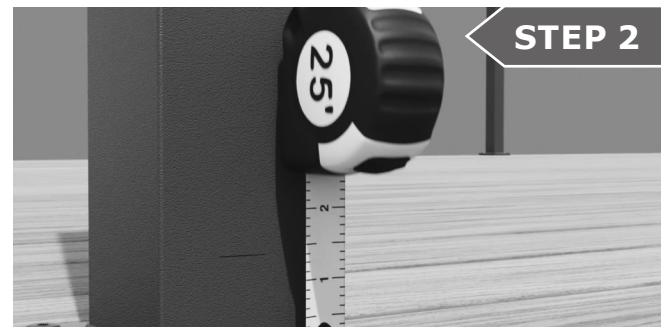

Measure 1-3/8" from the top of the flange and make a pencil mark at that height.

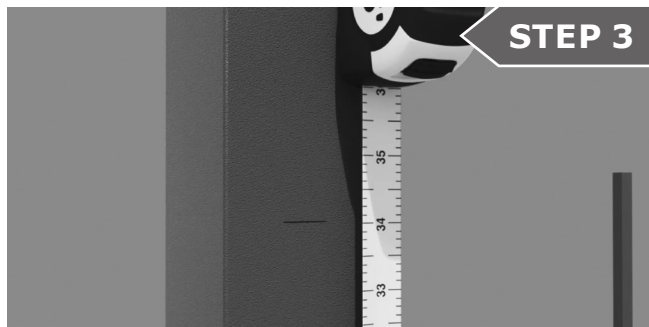

Place a pencil mark at 34" from the top of flange.



If you have our bracket template for 37" and 43" rails, place the template against the post and simply mark lines at the bottom of the desired bracket holes.

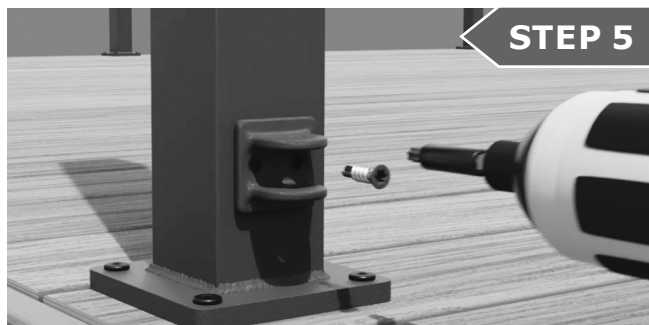

Place the angled bracket backer plate against the post horizontally at your mark and fasten to the post with two #14 Tek screws.



Attach the bottom bracket cup to the backer plate with a #14 Tek screw. Repeat the process for the top bracket.

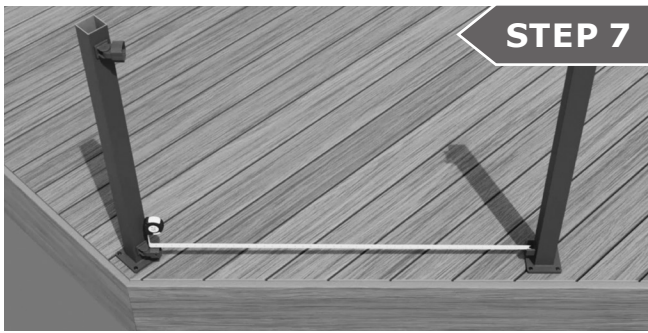

STEP 7

Measure the distance between the inside of the bracket cups while allowing a 1/4" gap to the back of the cups at each end. Take note of the measurement.

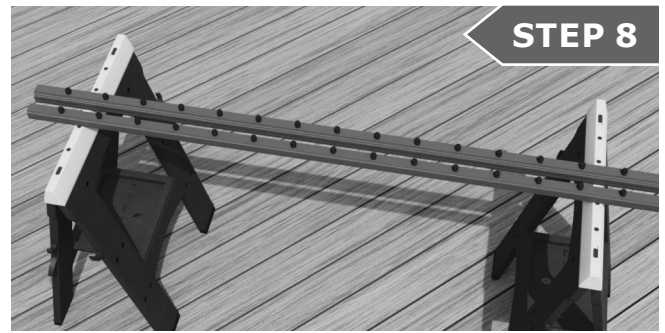

STEP 8

Place your rails on a flat surface, nubs side up, and mark your measurement with equal distances between the nubs, at both ends on both rails.

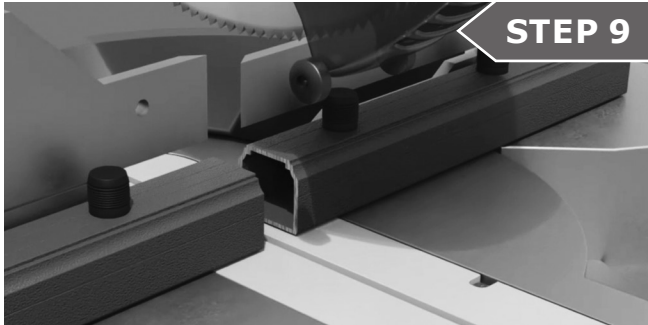

STEP 9

Cut the profiles square along your cut lines using a chop saw. Be sure to use a high tooth count blade.

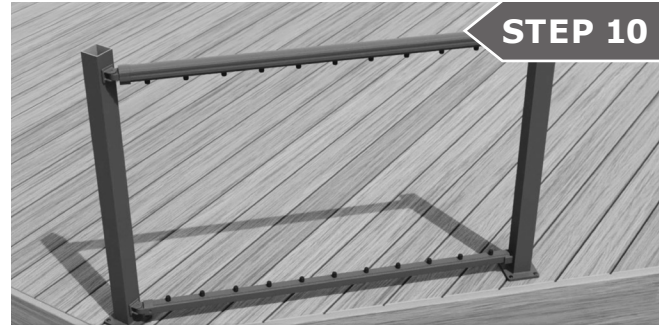

STEP 10

Place the rails in brackets with a 1/4" gap at each end.

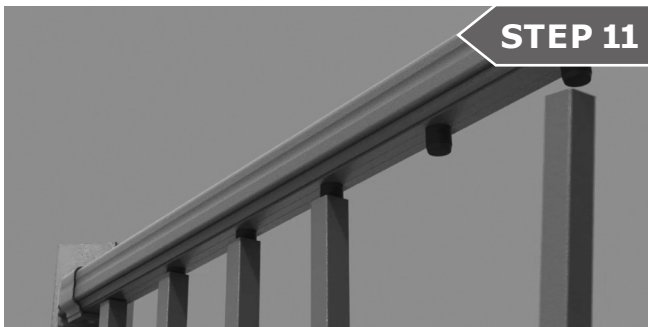

STEP 11

Starting at the angle bracket end, attach each picket one at a time using a slight up and down motion of the top rail as you work your way down.



STEP 12

Attach the bottom rail to the bracket cup with a #14 Tek screw.

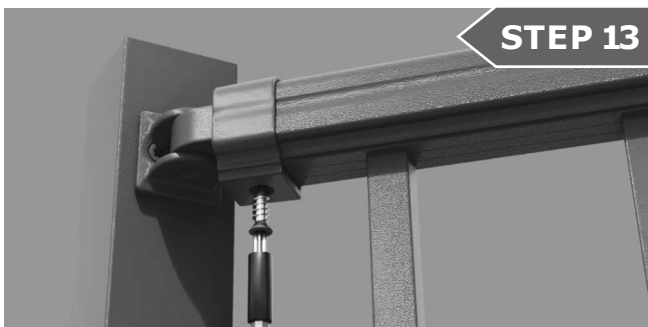

STEP 13

Attach the top rail to the bracket cup with a #14 Tek screw.

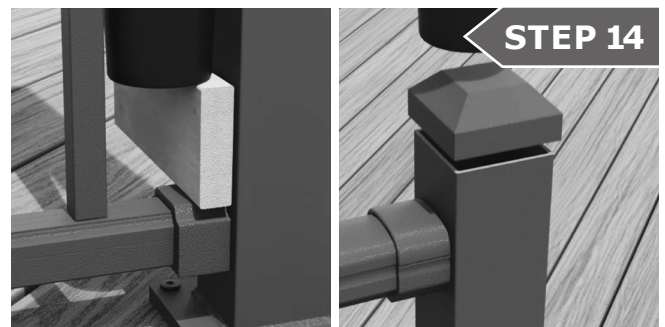

STEP 14

Use a 3/4" board and a rubber mallet at the back of the brackets to tap the bracket covers into place. Use the rubber mallet to tap the post cap into place.

OPTIMUM
ALUMINUM RAILING by **FDS**

543 E. 600 S. Provo, UT 84606
844-332-5338 | OptimumRailing.com